

A close-up photograph of a child's feet wearing blue jeans and black sneakers with white laces and soles. The feet are resting on a bright red plastic wheelbarrow. The wheelbarrow is positioned in a garden with several tulips in the background. The tulips have yellow and orange petals. The background is a clear blue sky. The overall scene is bright and cheerful, suggesting a sunny day in a well-maintained garden.

Water-wise
Landscape Design
"Kid Friendly Back Yard"

Trees/Shrubs



Eastern Redbud
Cercis canadensis

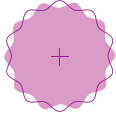

London Plane Tree
Platanus acerifolia

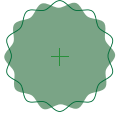

Dwarf Nectarine
Prunus persica
'Mericrest'



Contorted Filbert
Corylus avellana
'Contorta'



Oregon Grape
Mahonia repens



Clematis
Clematis patens
'The President'



Grass/Perennials



Feather Reed Grass
Calamagrostis x acutiflora
'Karl Foerster'



Chocolate Flower
Berlandiera lyrata



Silver Sage
Salvia argentea



Mexican Hat
Ratibida columnifera



Peony
Paeonia lactiflora 'Dr. Alexander Fleming'



Geranium
Geranium sanguineum striatum



Lamb's Ear
Stachys byzantina
'Silver Carpet'



Daylily
Hemerocallis
'Hyperion'



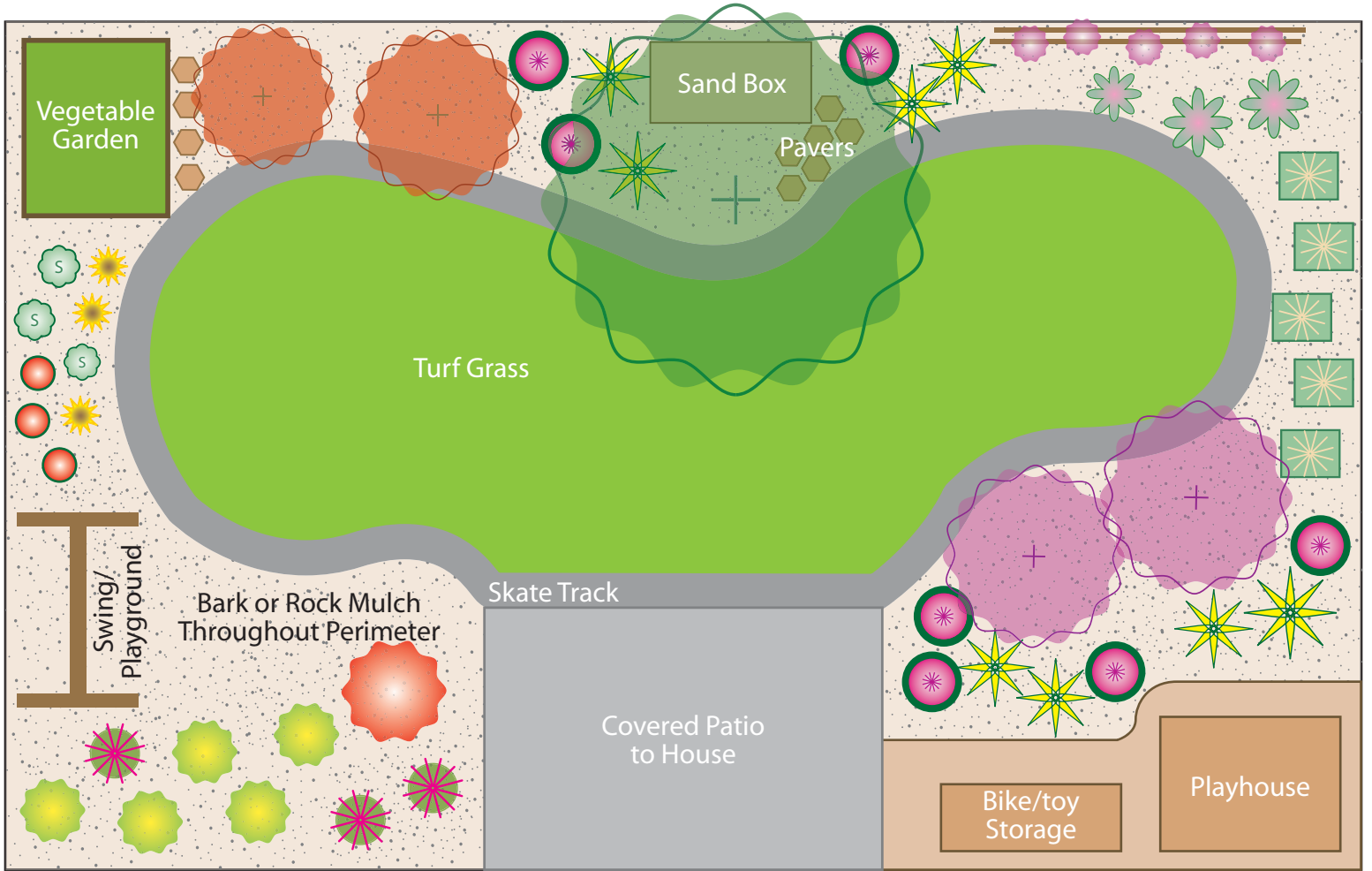

On the cover

Springtime in the Conservation Garden Park is conducive to kid play. Bring your children by to experience all the joys of spring, while you learn more about water-wise landscaping.

Resources

Conservation Garden Park at Jordan Valley:
www.conservationgardenpark.org

Utah State University Cooperative Extension:
<http://extension.usu.edu/>

Utah Division of Water Resources:
www.conservewater.utah.gov

Central Utah Water Conservancy District:
www.cuwcd.org

Please remember to check your local planning and zoning ordinances before proceeding with a water-wise landscape.



“Kid-Friendly Back Yard” Landscape Design: #5 in a series of sample landscape designs

Got young children? If you do, then you know how important it is to provide a place for them to play, release energy, and express creativity. Why not start with your own back yard?

This sample landscape design, created by parents of small children, combines many elements of a safe, kid-friendly wonderland with all the principles of a water-wise landscape. Children will enjoy the large climbing tree (London Plane Tree), concrete track for skating and biking,

open lawn area, sand box, vegetable garden, playhouse, swing or playground area, and plants with interesting characteristics. The water-wise plants in the design are chosen for their colorful blooms, tasty fruit, interesting smells, fun textures, or weird growth habits; and grouped generally according to their water requirement. Homeowners are encouraged to incorporate many of these ideas in their own yards for functionality, water conservation, and beauty in all the seasons.

Match the plant to its characteristics:

London Plane Tree
Fruit tree varieties
Eastern Redbud
Clematis varieties
Contorted Filbert
Oregon Grape
Feather Reed Grass
Lamb’s Ear
Chocolate Flower
Mexican Hat
Silver Sage
Peony varieties
Daylily varieties
Geranium varieties

Large, fuzzy gray leaves; tall white blooms in spring
Bright yellow blooms, purple fruit, leaves turn to burgundy
Serpentine branching habit
Classic perennial flower, usually yellow or orange
Perennial with oddly-shaped leaves and pink/blue flowers
Seedheads turn to golden color late in season
Climbing vine with large bright blooms
Velvety-soft leaf texture
Flower resembles a tall hat
Tree with bright pink spring blossoms
Large sturdy branches, unusual bark patterns
Flowers smell like cocoa
Tasty fruit
Large, ultra-bright rose-like flowers

The Conservation Garden Park is located at 8215 South 1300 West in West Jordan. Visit www.conservationgardenpark.org for details.



JORDAN VALLEY WATER
CONSERVANCY DISTRICT